

VENTED OIL GAGES

G300 SERIES

The G300 Series vented brass oil gage has a straight hex base with male pipe thread. A shield with machined viewing window surrounds the tubular glass sight. The viewing window has 360° adjustment for optimal orientation to view fluid after installation. The sealing gaskets are contained on both their ID and OD to facilitate trouble-free assembly after on-site repositioning of the viewing window.

Standard Features:

- Gage base machined from brass hex bar stock
- Male tapered pipe thread base connection (1/8, 1/4 or 3/8 inch NPTF)
- .39 inch wide viewing window, length varies from 1.79 to 7.33 inches depending on gage selected
- 360° adjustment of viewing window
- Suitable for use with most machine lubricating oils

Standard Materials:

- Brass construction
- Buna N seals
- Borosilicate glass sight

Temperature Rating:

- Maximum operating temperature of 250°F (121°C) with standard Buna N seals. For applications not compatible with Buna N seal material, consult factory for available options and corresponding temperature ratings.

Note:

- Oil Gage Modifications are available, please see Appendix LE-1 on page LE-A1 for more information.

G300 Series					
Part No.	A NPTF	B inches (mm)	C inches (mm)	D inches (mm)	HEX FLATS
G62-1	1/8	.79 (20.07)	1.79 (45.47)	3.06 (77.72)	.50 (12.70)
G301-2	1/4	1.06 (26.87)	.83 (21.08)	2.48 (62.99)	.69 (17.53)
G302-1	1/8	.87 (22.10)	1.33 (33.78)	2.29 (58.17)	.69 (17.53)
G302-2	1/4	1.06 (26.87)	1.33 (33.78)	2.98 (75.69)	.69 (17.53)
G302-3	3/8	1.06 (26.87)	1.33 (33.78)	2.98 (75.69)	.69 (17.53)
G303-1	1/8	.87 (22.10)	1.83 (46.48)	3.29 (83.57)	.69 (17.53)
G303-2	1/4	1.06 (26.87)	1.83 (46.48)	3.48 (88.39)	.69 (17.53)
G303-3	3/8	1.06 (26.87)	1.83 (46.48)	3.48 (88.39)	.69 (17.53)
G304-2	1/4	1.06 (26.87)	2.33 (59.18)	3.98 (101.09)	.69 (17.53)
G304-3	3/8	1.06 (26.87)	2.33 (59.18)	3.98 (101.09)	.69 (17.53)

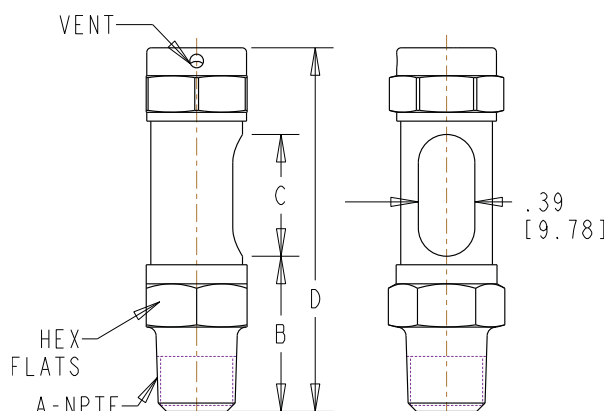

NOTE: All dimensions are inches [mm]

G300 Series (cont'd)					
Part No.	A NPTF	B inches (mm)	C inches (mm)	D inches (mm)	HEX FLATS
G305-2	1/4	1.06 (26.87)	2.83 (71.88)	4.48 (113.79)	.69 (17.53)
G305-3	3/8	1.06 (26.87)	2.83 (71.88)	4.48 (113.79)	.69 (17.53)
G306-2	1/4	1.06 (26.87)	3.33 (84.58)	4.98 (126.49)	.69 (17.53)
G306-3	3/8	1.06 (26.87)	3.33 (84.58)	4.98 (126.49)	.69 (17.53)
G307-1	1/8	.87 (22.10)	4.33 (109.98)	5.79 (147.07)	.69 (17.53)
G307-2	1/4	1.06 (26.87)	4.33 (109.98)	5.98 (151.89)	.69 (17.53)
G307-3	3/8	1.06 (26.87)	4.33 (109.98)	5.98 (151.89)	.69 (17.53)
G308-2	1/4	1.06 (26.87)	5.33 (135.38)	6.98 (177.29)	.69 (17.53)
G308-3	3/8	1.06 (26.87)	5.33 (135.38)	6.98 (177.29)	.69 (17.53)
G309-2	1/4	1.06 (26.87)	7.33 (186.18)	8.98 (228.09)	.69 (17.53)
G309-3	3/8	1.06 (26.87)	7.33 (186.18)	8.98 (228.09)	.69 (17.53)

Dimensions and specifications are subject to change without notice. Not all items are Made-To-Stock, contact us for availability.

02/14

Ph : 920-682-6877
Fx : 920-684-7210

LDI Industries

sales@ldi-industries.com
www.ldi-industries.com